

- PUSH type collet used mainly on turning, CNC, special purpose machines, ect.
- High clamping accuracy, high speed and high rigidity.
- The installation is the same as "Thru-hole power chuck" and they are replaceable with each other. No need to change the "Draw tube".
- Sealed against swarf, chips and coolant.
- The collet used must accord with DIN 6343.
- Patent numbers :
 Taiwan : PAT.NO.M380842
 China : PAT.NO.ZL2010 20113762.X

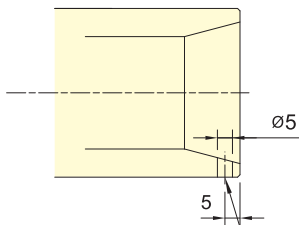

The hole and lock pin is option.
 *Note : While clamp square or hexagonal material, please order hole and lock pin of collet chuck.

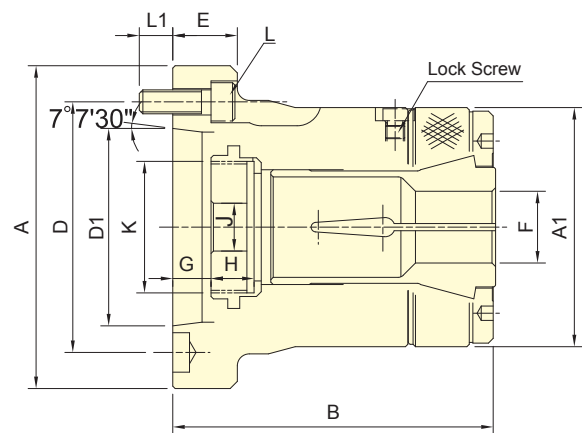

Subject to technical changes

SPECIFICATIONS

Model	Plunger stroke	Max. Chucking Capacity			Max. D.B. pull	Max. clamping force	Max. speed	I	Weight	Matching steel collet	Matching Cyl.	Max. pressure	
		Round	Hexagom	Square									
	mm	mm	mm	mm	kN (kgf)	kN (kgf)	min ⁻¹ (r.p.m.)	kg·m ²	kg			MPa (kgf/cm ²)	
CL-26	A4	4.5	3~26	4~22	4~18	17.6(1800)	37.9(3870)	8000	0.040	4.2	161E	TK-A533	2.4(24)
CL-30	A4	4.5	3~30	4~26	4~20	19.6(2000)	42.1(4300)	8000	0.038	4.1	163E	TK-A533	2.7(27)
CL-36	A5	6	3~36	6~32	6~26	22.5(2300)	48.5(4950)	6000	0.058	6.3	171E	TK-C643	2.3(23)
CL-42	A5	6	3~42	6~36	6~29	24.5(2500)	52.9(5400)	6000	0.057	6.1	173E	TK-C643	2.5(25)
CL-42	A6	6	3~42	6~36	6~29	24.5(2500)	52.9(5400)	6000	0.061	7.5	173E	TK-C643	2.5(25)
CL-52	A6	6	5~52	8~45	7~36	27.4(2800)	59.0(6020)	6000	0.093	13.8	177E	TK-A853	2.0(20)
CL-60	A6	6	5~60	8~52	7~42	29.4(3000)	63.7(6500)	5000	0.091	13.5	185E	TK-1068	1.8(18)
CL-60	A8	6	5~60	8~52	7~42	29.4(3000)	63.7(6500)	5000	0.104	14.5	185E	TK-1068	1.8(18)
CL-80	A8	6	20~80	18~69	15~56	34.3(3500)	71.5(7300)	4000	0.120	19.8	193E	TK-A1287	1.6(16)

DIMENSIONS

Model	A	A1	B	D	D1	E	F max.	F min.	G max.	G min.	H	J	K max.	L	L1	
CL-26	A4	110	85	108	82.6	63.51	25	26	3	9.5	5	15	12	M40x1.5	3~M10x30	15
CL-30	A4	110	85	108	82.6	63.51	25	30	3	9.5	5	15	12	M40x1.5	3~M10x30	15
CL-36	A5	135	100	130	104.8	82.56	27	36	3	14	8	17.5	20	M55x2	4~M10x30	14
CL-42	A5	135	100	130	104.8	82.56	27	42	3	14	8	17.5	20	M55x2	4~M10x30	14
CL-42	A6	165	100	130	133.4	106.38	32	42	3	17	11	17.5	20	M60x2	4~M12x35	16
CL-52	A6	170	130	154	133.4	106.38	27	52	5	10.5	4.5	24	45	M60x2	4~M12x35	20
CL-60	A6	170	130	154	133.4	106.38	27	60	5	10.5	4.5	24	45	M75x2	4~M12x35	20
CL-60	A8	210	130	147.5	171.5	139.72	35	60	5	3.5	-2.5	24	45	M85x2	4~M16x40	22
CL-80	A8	210	156	175	171.5	139.72	35	80	20	7.5	1.5	22	45	M100x2	6~M16x40	22