

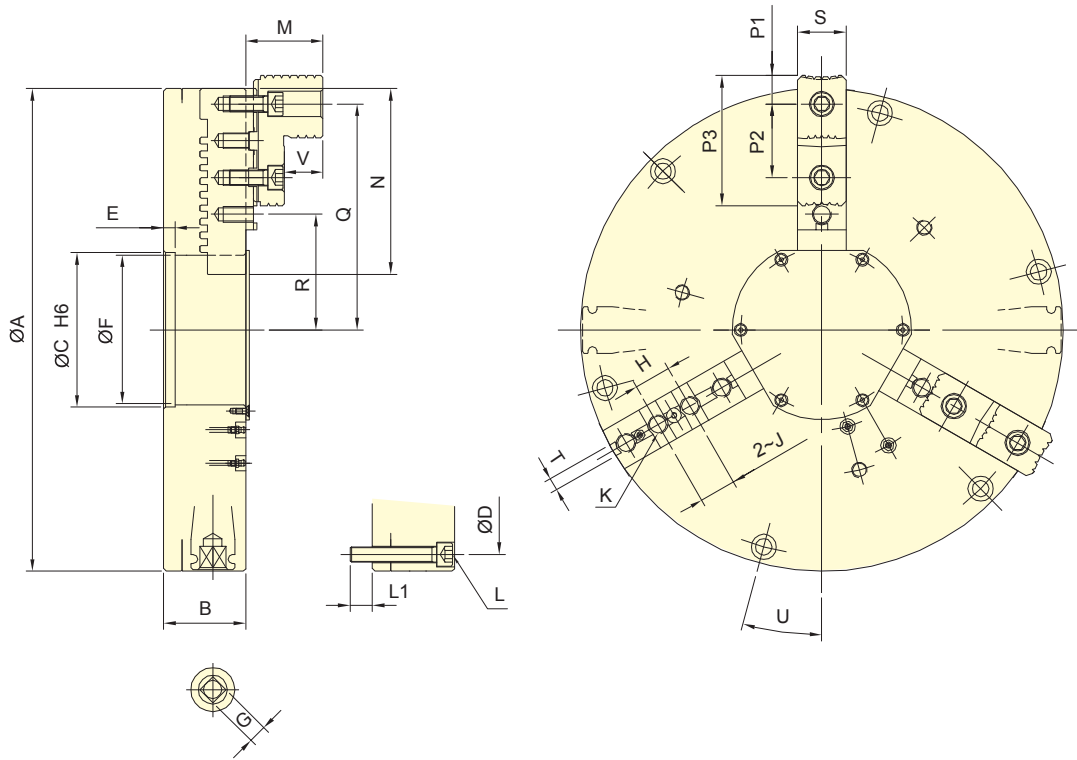

- 薄型與輕量化設計專用於五軸分度盤與銑削加工機，可充分增加作業空間。
- 中心孔防塵蓋設計，使切屑不易進入夾盤內部，以確保夾盤的使用壽命及精度。
- Thin and lightweight design and increase the z-axis machining range.
- With the center hole cover and dustproof design for the accuracy and service life of the chuck.
- For 5-axis indexing plates and milling machines.
- 本系列產品並不可直接安裝於臥式或立式車床，除非能提供足夠強度與剛性之背板給予支撐。
- 3MF series are not designed for the vertical or horizontal lathes, unless there is a rigid plate and providing adequate support rigidity and strength.



保留規格修改的權利  
Subject to technical changes

### 技術規格 SPECIFICATIONS

型號 Model	爪行程(直徑) Jaw stroke (Dia.)	夾持直徑 Chucking Dia.		最大容許扭矩 Max. allowable torque	最大夾持力 Max. clamping force	最高迴轉數 Max. speed	重量 Weight
		最大 Max.	最小 Min.				
3MF-16	60	350	95	175 (17.8)	59 (6000)	1450	66.9
3MF-20	80	500	142	170 (17.3)	71.2 (7300)	1150	121

### 外型尺寸 DIMENSIONS

Model	A	B	C (H6)	D	E	F	G	H	J (H7)	K	L	L1	M
3MF-16	400	80	140	375	10	135	□ 14	27	19.03	4~M12	6~M12	23	60
3MF-20	500	85	170	465	12	160	□ 19	38.1	19.03	4~M16	6~M16	23	80

Model	N	P1	P2	P3	Q max.	Q min.	R max.	R min.	S	T (h8)	U	V
3MF-16	148.5	27.16	54	112.5	184.5	164	103	62	40	12.7	15°	28
3MF-20	192.5	29.5	76.2	135	254	214	139.7	99.7	50	12.7	15°	40