

- 薄型與輕量化設計專用於五軸分度盤與銑削加工機，可充分增加作業空間。
- 中心孔防塵蓋設計，使切屑不易進入夾盤內部，以確保夾盤的使用壽命及精度。
- Thin and lightweight design and increase the z-axis machining range.
- With the center hole cover and dustproof design for the accuracy and service life of the chuck.
- For 5-axis indexing plates and milling machines.
- 本系列產品並不可直接安裝於臥式或立式車床，除非能提供足夠強度與剛性之背板給予支撐。
- 3MF series are not designed for the vertical or horizontal lathes, unless there is a rigid plate and providing adequate support rigidity and strength.

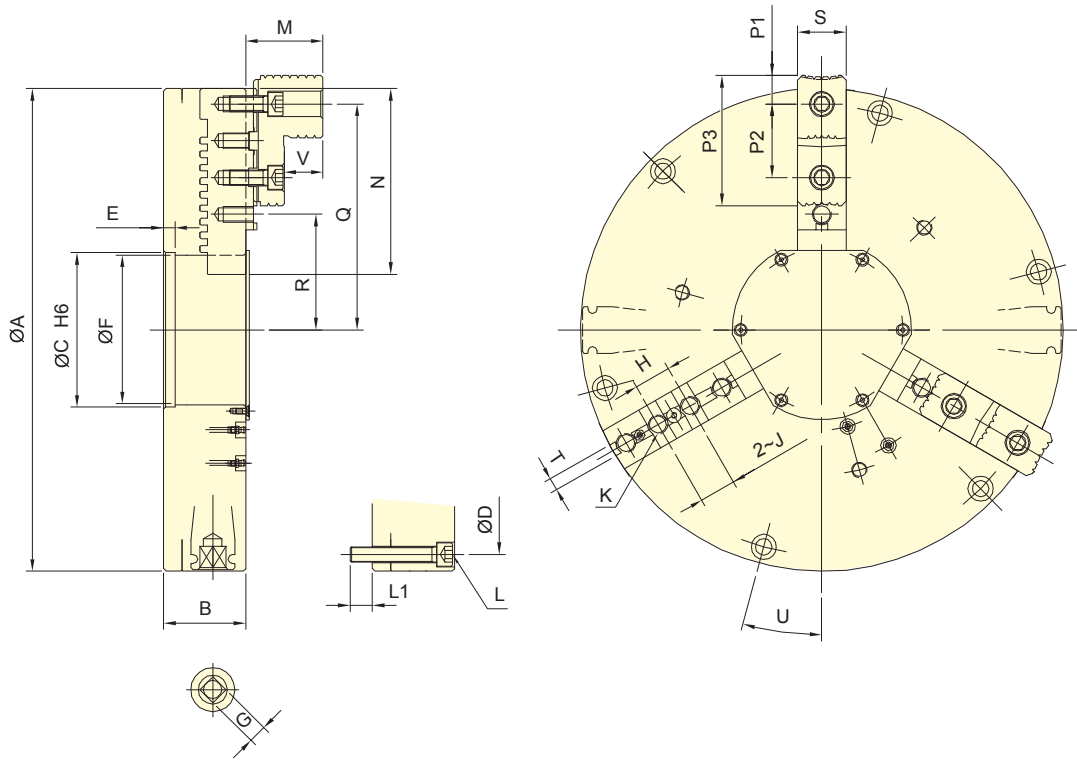

保留規格修改的權利
Subject to technical changes

技術規格 SPECIFICATIONS

型號 Model	爪行程(直徑) Jaw stroke (Dia.)	夾持直徑 Chucking Dia.		最大容許扭矩	最大夾持力	最高迴轉數	重量
	mm	最大 Max. mm	最小 Min. mm	Max. allowable torque N · m (kgf · m)	Max. clamping force kN (kgf)	Max. speed min ⁻¹ (r.p.m.)	Weight kg
3MF-16	60	350	95	175 (17.8)	59 (6000)	1450	66.9
3MF-20	80	500	142	170 (17.3)	71.2 (7300)	1150	121

外型尺寸 DIMENSIONS

Model	A	B	C (H6)	D	E	F	G	H	J (H7)	K	L	L1	M
3MF-16	400	80	140	375	10	135	□ 14	27	19.03	4~M12	6~M12	23	60
3MF-20	500	85	170	465	12	160	□ 19	38.1	19.03	4~M16	6~M16	23	80

Model	N	P1	P2	P3	Q max.	Q min.	R max.	R min.	S	T (h8)	U	V
3MF-16	148.5	27.16	54	112.5	184.5	164	103	62	40	12.7	15°	28
3MF-20	192.5	29.5	76.2	135	254	214	139.7	99.7	50	12.7	15°	40